

# Tristel Fuse™ for Stella

**Tristel Fuse for Stella is a single-use disinfectant solution designed specifically for use in Stella for the high-level disinfection of semi-critical medical devices.**

Tristel Fuse for Stella incorporates two separate compartments that contain 50ml Tristel Base solution (citric acid) and 50ml Tristel Activator solution (sodium chlorite). When mixed upon bursting the sachet, Tristel's proprietary chlorine dioxide chemistry is generated for dilution into five litres of water.



## COMPATIBLE

Tristel Fuse for Stella has been tested and confirmed to be compatible with medical device manufacturers, including\*:

- BK Medical
- Canon Medical Systems
- Carestream
- Esaote
- Fujifilm
- Gaeltec
- Hitachi
- Karl Storz
- Philips
- Unisensor
- Xion Medical

\*Material compatibility refers to certain instruments/models.

## EFFECTIVE

Tristel Fuse for Stella is sporicidal, mycobactericidal, virucidal, fungicidal and bactericidal with a contact time of five minutes. Tristel Fuse for Stella has been extensively tested to the latest European Norm requirements and is compliant to EN 14885:2018. Tristel Fuse for Stella is effective against microorganisms of concern such as:

- *Bacillus species*
- *Mycobacteria species*
- *Candida albicans*
- *Aspergillus brasiliensis*
- Adenovirus
- Poliovirus
- Norovirus
- SARS-CoV-2\*
- *Pseudomonas aeruginosa*
- *Staphylococcus aureus*
- Vancomycin-resistant *Enterococcus faecium*

\*Based on EN14476 Virucidal activity.

## How to use Tristel Fuse for Stella

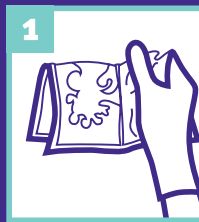

1 Fold the sachet in half and squeeze one side to burst contents through the centre seal. Contents will start to turn yellow. Allow 30 seconds mixing time.

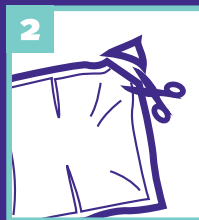

2 Tear or cut off a corner of the sachet.

*Note: Be careful when opening the packet so that you do not spill the concentrate.*

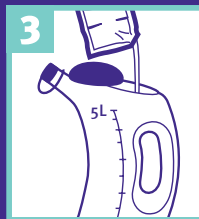

3 Pour contents into five litres of ambient water.

*Note: Do not use hot water.*

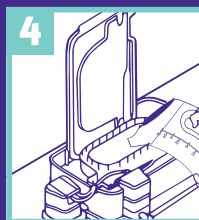

4 Add the prepared Tristel Fuse for Stella solution to the inner compartment of the base when prompted by Stella IQ and follow further instructions on the screen.



5 The cycle time for high-level disinfection is five minutes. At the end of the cycle, Stella performs an automatic emptying.

Please refer to Stella's detailed user manual as well as additional wall charts and guides.

Tristel Fuse for Stella is CE marked as a Class IIb Medical Device in accordance with the European Medical Devices Directive 93/42/EEC and the 2007/47/EC amendments thereto.

**Tristel™**  
WE HAVE CHEMISTRY.

Created by: Tristel Solutions Limited, Lynx Business Park, Cambs, UK, CB8 7NY  
T +44 (0) 1638 721500 - E mail@tristel.com - W www.tristel.com

Malaysia: Tristel Malaysia Sdn. Bhd, A-25-3A Pinnacle PJ, Lorong Utara C,  
46200 Petaling Jaya, Selangor Darul Ehsan, Malaysia  
T +603 79317791 - F +603 79319971 - E mail-my@tristel.com

Hong Kong & Taiwan: Tristel Asia Limited, 21st Floor,  
168 Electric Road, Fortress Hill, Hong Kong  
T +852 2895 6968 - E customerservicehk@tristel.com

Copyright © Tristel Solutions  
Mkt-Fac-1286-1  
August 2020

Information on Tristel's patents can be seen at: <http://www.our-patents.info/tristel>

Page 1 of 1